



REGIONAL INSTITUTE OF EDUCATION :
BHUBANESWAR
(CAMPUS & WELFARE SECTION)

No. RIEB/C&W/ 9980

Date: 08.12.2020

EXPRESSION OF INTEREST

The Principal, RIE, Bhubaneswar invites Expression of Interest (EOI) from the reputed firms and suppliers for finalisation of rate/quality/quantity of the furniture's to be purchased through GeM bidding at the earliest. Interested firms/suppliers may go through the details available in the Institute website <http://www.riebbs.ac.in> and www.riebbs.ori.nic.in

Administrative Officer



REGIONAL INSTITUTE OF EDUCATION:
BHUBANESWAR
(CAMPUS & WELFARE SECTION)

No. RIEB/C&W/ 9980

Date: 08.12.20

EXPRESSION OF INTEREST

The Principal, RIE, Bhubaneswar invites Expression of Interest (EOI) from the reputed firms and suppliers for finalisation of rate/quality/quantity of the furniture's to be purchased through GeM bidding at the earliest :-

1. Furniture's for 70 Seater Conference Hall

SL No	Name of Item & Specification	Qty.
a.	Dias Chair: - Supplying and placing in position of High Back chair as per photograph. Overall height 1280mm max, 1180mm min, overall size (W) 590mm X (H) 1180mm – 1280mm, seat and back are made up of 12-15mm thick hot pressed, two piece ply wood upholstered with leatherette and moulded with polyurethane foam. The back plywood shall be designed with contoured lumbar support for extra comfort. The chair shall have a centre tilt mechanism with 17 degree max. Tilt and tilt tension adjustment, upright locking facility and full 360 degrees swivel mechanism, One piece arm rest should be made up of chrome finish with leatherette patch. The arm rests are fitted to the seat and back with 6mm dia. And 64mm long screw made of HR steel. The prong (base) is made of metal chrome finish and fitted with 5nos. twin wheel castors (castor wheel dia. 50-60mm). The Prong (base) is 650mm pitch centre dia (700mm with castors). The pneumatic height adjustment shall have adjustment stroke of 75 mm and shall be operated at 30kgs extension force. Material should be from SEFA & BFMA Certified Companies. Complete as per approved make of image and specification under the guidance of Engineer in charge.	06
b.	Hall Chair: - Supplying and placing in position of Low Back Chair for Conference Room. Overall height (H) 1005mm-1115mm, overall size:- (W), 590MM X (D) 505MM X (H) 1005MM- 1115MM, seat and back are made of 12mm thick hot pressed, two piece ply wood upholstered with leatherette and moulded with polyurethane foam. The back play wood shall be designed with contoured lumbar support for extra comfort. The chair shall have a center tilt mechanism with 17degree amx. Tilt and tilt tension adjustment, upright locking facility and full 360degrees swivel arm rests are fitted to the seat and back with 6mm dia. And 64 mm long screw made of HR Steel. The prong (base) is made of metal chrome finish and fitted with 5 Nos. twin wheel castors (castor pneumatic height adjustment shall have adjustment stroke of 75mm and shall be operated at 30kgs extension force. Material should be from SEFA * BEFA Certified Companies. Complete as per approved make of image and specification under the guidance of Engineer in Charge. Material should be from SEFA & BEFA Certified Companies. Complete as per approved make of image and specification under the guidance of Engineer in Charge.	74
c.	Dias Table :- Free Standing Table Size :- Size : 1350L x 600W x 750/900Ht Providing and fixing Free standing table, Tabletop made out of 25mm thik Prelaminated particle board with machine pressed 2MM thick PVC edging	02 Nos.

	using special hot melt glue at hot temperature. Table top supported with 18mm thk Prelam Particle board Side panel and Modesty panel (900mm Height) with machine pressed 2MM thick PVC edging using special hot melt glue at hot temperature. Provision of powder coated finished Metal raceway with Electrical pole for wire management below tabletop. (PRELAMINATED PARTICLE BOARD :- INTERIOR GRADE TYPE II)	
d.	Audience Table :- Free Standing Table Size : 2100L x 600W x 750/900Ht Size : 1350L x 600W x 750/900Ht Providing and fixing Free standing table, Tabletop made out of 25mm thk Prelaminated particle board with machine pressed 2MM thick PVC edging using special hot melt glue at hot temperature. Table top supported with 18mm thk Prelam Particle board Side panel and Modesty panel (900mm Height) with machine pressed 2MM thick PVC edging using special hot melt glue at hot temperature. Provision of powder coated finished Metal raceway with Electrical pole for wire management below tabletop. (PRELAMINATED PARTICLE BOARD :- INTERIOR GRADE TYPE II)	Two Seater 16 Nos. Three Seater 14 Nos.

2. Furniture's for 100 Seater Conference Hall

SL No	Name of Item & Specification	Qty.
a.	Dias Chair: - Supplying and placing in position of High Back chair as per photograph. Overall height 1280mm max, 1180mm min, overall size (W) 590mm X (H) 1180mm – 1280mm, seat and back are made up of 12-15mm thick hot pressed, two piece ply wood upholstered with leatherette and moulded with polyurethane foam. The back plywood shall be designed with contoured lumbar support for extra comfort. The chair shall have a centre tilt mechanism with 17 degree max. Tilt and tilt tension adjustment, upright locking facility and full 360 degrees swivel mechanism, One piece arm rest should be made up of chrome finish with leatherette patch. The arm rests are fitted to the seat and back with 6mm dia. And 64mm long screw made of HR steel. The prong (base) is made of metal chrome finish and fitted with 5nos. twin wheel castors (castor wheel dia. 50-60mm). The Prong (base) is 650mm pitch centre dia (700mm with castors). The pneumatic height adjustment shall have adjustment stroke of 75 mm and shall be operated at 30kgs extension force. Material should be from SEFA & BFMA Certified Companies. Complete as per approved make of image and specification under the guidance of Engineer in charge.	06
b.	Hall Chair: - Supplying and placing in position of Low Back Chair for Conference Room. Overall height (H) 1005mm-1115mm, overall size:- (W), 590MM X (D) 505MM X (H) 1005MM- 1115MM, seat and back are made of 12mm thick hot pressed, two piece ply wood upholstered with leatherette and moulded with polyurethane foam. The back play wood shall be designed with contoured lumbar support for extra comfort. The chair shall have a center tilt mechanism with 17degree amx. Tilt and tilt tension adjustment, upright locking facility and full 360degrees swivel arm rests are fitted to the seat and back with 6mm dia. And 64 mm long screw made of HR Steel. The prong (base) is made of metal chrome finish and fitted with 5 Nos. twin wheel castors (castor pneumatic height adjustment shall have adjustment stroke of 75mm and shall be operated at 30kgs extension force. Material should be from SEFA * BEFA Certified Companies. Complete as per approved make of image and specification under the guidance of Engineer in Charge. Material should be from SEFA & BEFA Certified Companies. Complete as per approved make of image and specification under the guidance of Engineer in Charge.	98

c.	Dias Table :- Free Standing Table Size :- Size : 1350L x 600W x 750/900Ht Providing and fixing Free standing table, Tabletop made out of 25mm thik Prelaminated particle board with machine pressed 2MM thick PVC edging using special hot melt glue at hot temperature. Table top supported with 18mm thik Prelam Particle board Side panel and Modesty panel (900mm Height) with machine pressed 2MM thick PVC edging using special hot melt glue at hot temperature. Provision of powder coated finished Metal raceway with Electrical pole for wire management below tabletop. (PRELAMINATED PARTICLE BOARD :- INTERIOR GRADE TYPE II)	02 Nos.
d.	Hall Table :- Free Standing Table Size : 1350L x 600W x 750/900Ht Providing and fixing Free standing table, Tabletop made out of 25mm thik Prelaminated particle board with machine pressed 2MM thick PVC edging using special hot melt glue at hot temperature. Table top supported with 18mm thk Prelam Particle board Side panel and Modesty panel (900mm Height) with machine pressed 2MM thick PVC edging using special hot melt glue at hot temperature. Provision of powder coated finished Metal raceway with Electrical pole for wire management below tabletop. (PRELAMINATED PARTICLE BOARD :- INTERIOR GRADE TYPE II)	Two Seater 48 Nos.

General Terms and Conditions :-

1. The reputed firms and suppliers having registrations on GeM portal are requested to participate in the Expression of Interest. They are requested to submit the best competitive rate of each item (Unit price). They are also requested submit a coloured copy of the materials alongwith the rates for evaluation of the materials. The EOI may be submitted by hand in the office or send by email to socwriebbsr16@gmail.com in PDF form latest by 17.12.20
2. A duly constituted committee will evaluate all the EOIs and the Committee members may visited to the shortlisted firms for physical verification of the credential of the firm and quality of sample materials.
3. After due approval of the competent authority the same items will be purchased through PAC Biding in GeM portal.
4. The interested firms are requested to submit the required details of rate/design of the materials properly designed in their own letter pad only.
5. The materials should be supplied by the firm within a period of 42days of supply order positively or else the order will be cancelled. Detail procedure will be completed on GeM site as per rule.

The details of the notice inviting expression of interest is available in our web site:

<http://www.riebbs.ac.in> and www.riebbs.ori.nic.in

Principal, RIE, Bhubaneswar reserves the right to accept or reject the process in part/full without assigning any reason thereof.

8/12/2020
Administrative Officer

1

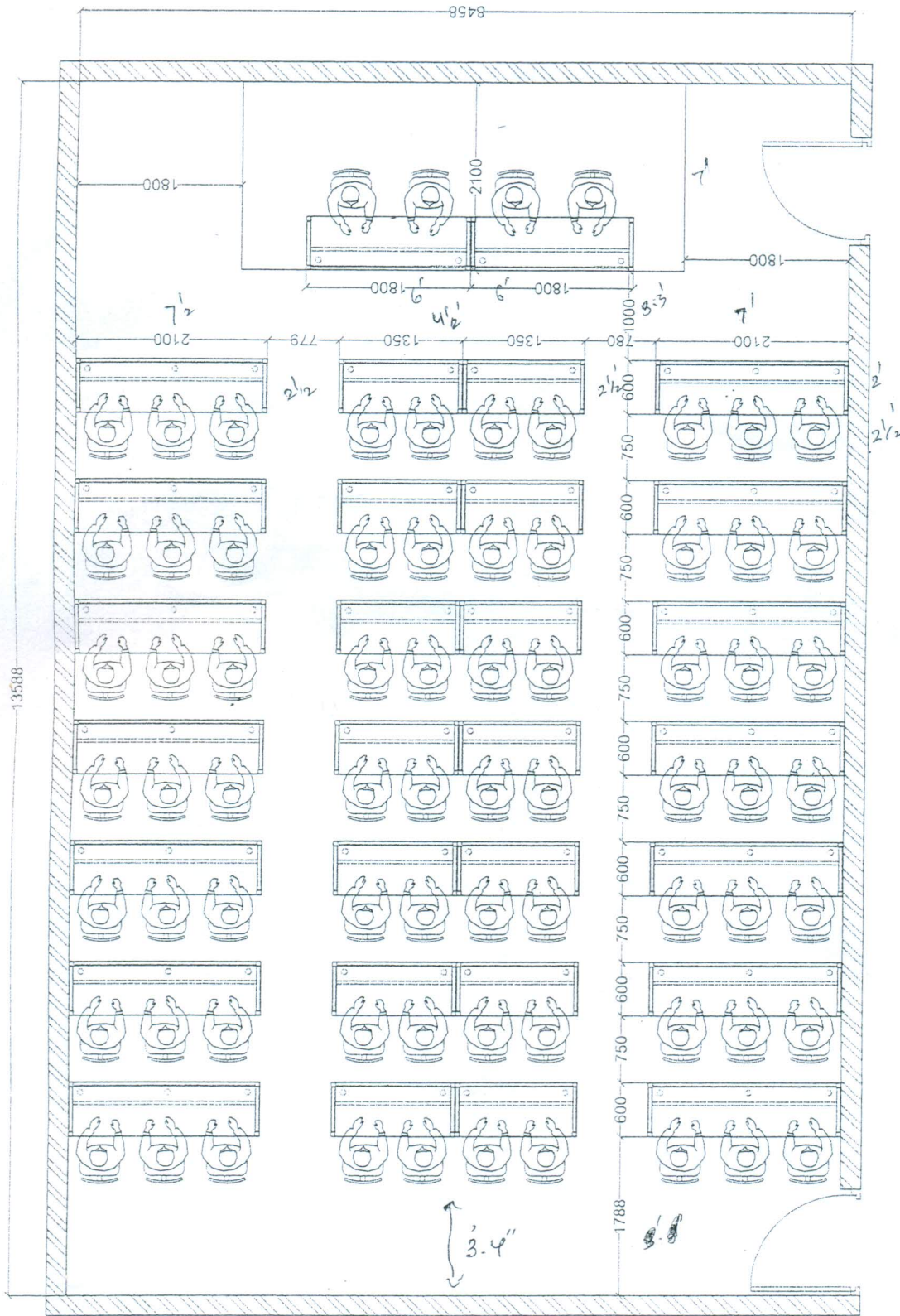

PLAN - LAYOUT - 70NOS SEATING.

	CLIENT: M/S REGIONAL INSTITUTE OF EDUCATION - BHUBANESWAR.		DRAWN BY : TAMSEEL.	
	PROJECT: SUPPLY OF MODULAR FURNITURE.		CHECKED BY :	
	THIS DRAWING BELONGS TO DURIAN INDUSTRIES LTD. IT CANNOT BE COPIED OR SCANNED WITHOUT WRITTEN PERMISSION FROM DURIAN INDUSTRIES LTD.		DATE: 31.08.2020.	
			SCALE: N.T.S.	REV: 6.
OFFICE FURNITURE		APPROVED BY		

4/9/20

04.09.2020

70

14.3/76

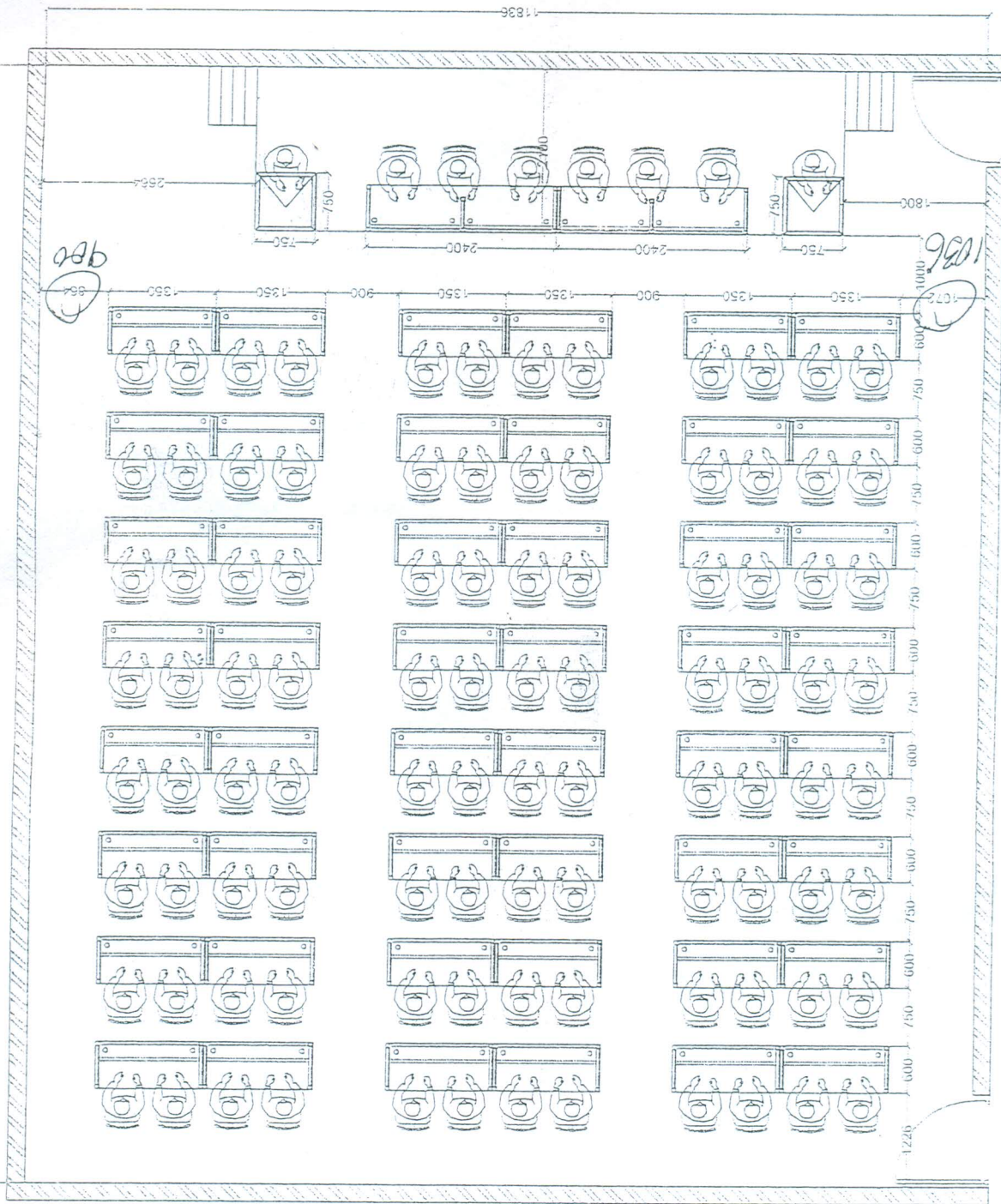

PLAN LAYOUT - 96NOS - SEATING

CLIENT: M/S REGIONAL INSTITUTE OF EDUCATION - BHUBANESWAR

PROJECT: SUPPLY OF MODULAR FURNITURE

THIS DRAWING BELONGS TO DURIAN INDUSTRIES LTD. IT CANNOT BE COPIED OR
SCANNED WITHOUT WRITTEN PERMISSION FROM DURIAN INDUSTRIES LTD

DRAWN BY : TAMSEEL

CHECKED BY :

DATE: 18.09.2020

SCALE: N.T.S. REV: 9

APPROVED BY



OFFICE FURNITURE

Handwritten signature
22.9.20